

MEET DREES & SOMMER NETHERLANDS

The merger with BOAG expands the range of services of Drees & Sommer Netherlands from 1 July 2020. The company supports clients in all aspects of housing, real estate and infrastructure, for small to very large and complex projects, nationally and internationally. Supported and carried by the Drees & Sommer SE with headquarters in Germany. And is there a better way to get to know us than through our projects?

PROJECTS BY BOAG

**NHOW AMSTERDAM
RAI HOTEL**
Amsterdam



With 650 rooms on 25 floors, the nhow Amsterdam RAI hotel is the largest newly built hotel in the Benelux countries. The most eye-catching feature is not just the sheer size of the hotel, but also the design, provided by OMA architectural studio, and the three stacked triangles required a very special construction. The four-star hotel is situated directly next to the RAI complex. The project developers COD and Being Development commissioned BOAG to monitor progress, quality and safe execution of the project.

Client: COD, Being Development
Business line: Construction Management

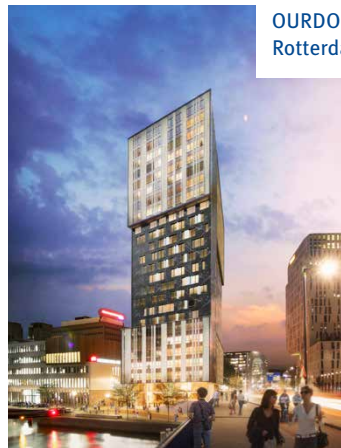

OURDOMAIN ROTTERDAM BLAAK
Rotterdam

OurDomain Rotterdam Blaak is a 70-metre high, residential tower block, with 24 floors, situated at the foot of the André van der Louw Bridge. The building has 612 apartments for students and young professionals, a 600 m2 roof terrace, 500 m2 of commercial space and services, a large parking area for bicycles, a lounge, a gym and a 24/7 hospitality space. BOAG and Stebru developed the residential block for international investor Greystar, with BOAG handling project management, general management and supervision during project realisation.

Client: Stebru Vastgoed
Business line: Project Management/Construction Management



CENTRAAL STATION AMSTERDAM
Amsterdam

The monumental Amsterdam CS railway station has been transformed into a contemporary station hall. Using structural breakthroughs in the historic building in front of the station, two doorless passages form links between the south and north sections of the station. The IJ Building, which forms the original monumental station terminal, has been restored with a new layout, and forms the link between the IJ Hall, the doorless passages and the existing passenger tunnels. BOAG assisted NS Stations with the tendering procedure, coordination and the handling of the three separate projects, as well as with management and supervision during the realisation phase.

Client: NS Stations
Business line: Project Management/Construction Management

PROJECTS BY DREES & SOMMER NETHERLANDS

POST
Rotterdam

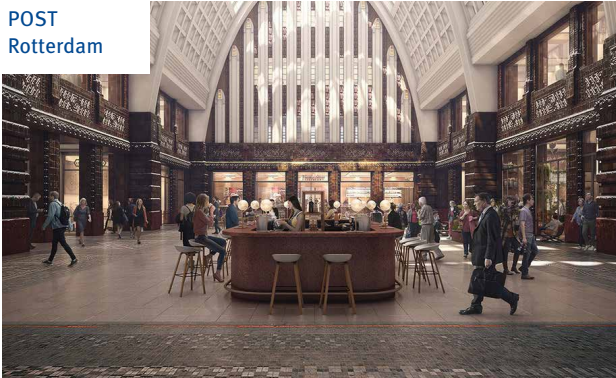

The legendary Post Office (Postkantoor) on the Coolsingel in Rotterdam has been standing vacant for more than a decade. But now new life is breathed into the monumental building: Omnam Group is refurbishing it into a new retail center with a luxury hotel and a highrise apartment building. Everyone is committed to the highest quality standards. Drees & Sommer is supporting the client with project management services such as the contractor selection procedure, building permits process and construction preparation.

Client: OMNAM
Business line: Project Management

RNHB
Utrecht



Following substantial growth, real estate financier RNHB was looking for new premises in Utrecht. Drees & Sommer Nederland provided the project management for the housing project. During the first phase, we supported RNHB with the selection of a suitable office location: the new WTC in Utrecht. We then supervised the construction and furnishing of the leased office floors.

Client: RNHB
Business line: Project Management

SDU
The Hague



In 2019, Sdu moved its office to this visible location on the Maanweg along the A12 highway. After working with Drees & Sommer in an earlier project, Sdu appointed the Project Management and consulting company to supervise their relocation process. As client representative, Drees & Sommer supervised quality, planning and budget during the renovation and fit-out of the new office.

Client: Sdu
Business line: Project Management/Change Management/
Workplace Consulting

INTERNATIONAL PROJECTS BY DREES & SOMMER

CUBE BERLIN
Berlin



With the support of Drees & Sommer, cube berlin – an office building as smart as it is spectacular – was completed in a construction period of just over three years. Built by CA Immo, cube berlin is in a prime location on Washington Platz, a square next to Berlin Central Station. Designed by 3XN Architects, the cube-shaped building is a unique combination of technology, architecture and sustainability. A holistic digitization strategy was developed and implemented in collaboration with the client, making cube berlin a flagship project that lays claim to being the smartest building in Europe.

Client: CA Immo Deutschland GmbH, Frankfurt
Business line: Digitization consulting/Building Services Engineering/Green Building certification



BBC HEADQUARTERS
London

As part of the BBC's long-term real estate strategy, the corporation wanted part of the iconic Television Centre in London transformed into a high tech, agile, global HQ for its commercial arm, BBC Worldwide. Working with two stakeholders, BBC Worldwide and landlord BBC Commercial Holdings, Drees & Sommer UK was appointed as project manager, with additional responsibility for managing the design team and other appointed parties. Starting with the strip-out of 11,000m² of existing offices, including significant asbestos removal, the refurbishment also involved major structural work.

Client: BBC Worldwide & BBC Commercial Holdings
Business line: Facility Management Consulting/
Project Management



**MERCEDES-BENZ
HEADQUARTERS**
Rome

In the search for a partner for tenancy management on occupying new office premises in Rome, Mercedes-Benz Italia engaged the services of Drees & Sommer. The automobile manufacturer's decision paid off. Drees & Sommer ensured that Mercedes-Benz Italia was able to move into its new headquarters on schedule and that the office building is of the standard of quality demanded by the Group.

Client: Mercedes-Benz Italia, Rome
Business line: Project Management/Facility management consulting